



Woburn Avenue, Epping, CM16

BUTLER  STAG



A fantastic studio apartment to rent in the heart of Theydon Bois.



- Studio Apartment
- Village Location
- Permit Parking
- Modern
- Close to Tube & Amenities
- First Floor

A fantastic studio apartment located on the first floor of this popular purpose built block. Presented in immaculate condition throughout with accommodation comprising entrance hallway, stylish bathroom and studio room with an open-plan kitchen, bedroom, and sitting room.

The village is arranged around the green, complete with duck pond, and offers a parade of shops, several pubs and restaurants and easy access into Epping Forest. Transport links into London are excellent and there are several well-regarded state and private schools within easy reach. Local leisure facilities include golf courses, sports centres and a tennis club.

Council Tax Band B





Woburn House, CM16

First Floor

Approx. 32 Sq. meters (344 Sq. feet)

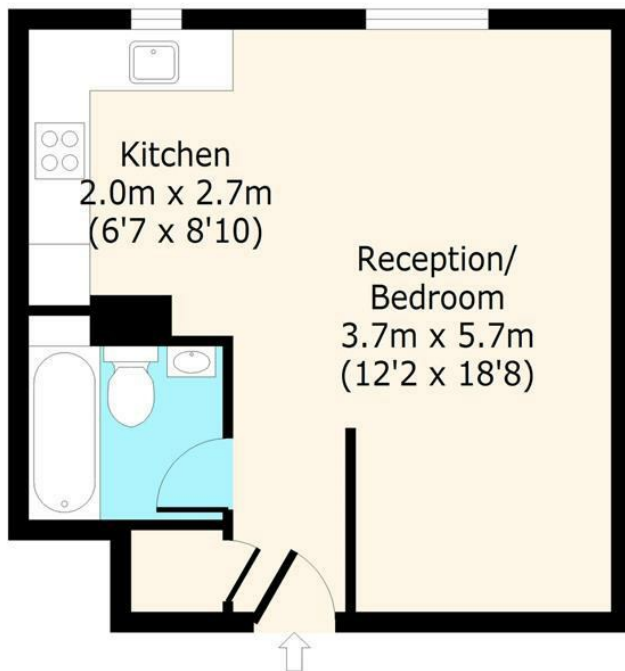

Total area: approx. 32 Sq. meters (344 Sq. feet)

For illustration purposes only - not to scale

www.londonpropertyassessments.co.uk

IMPORTANT NOTICE - These particulars have been prepared in good faith and they are not intended to constitute part of an offer or contract. We have not performed a structural survey on this property and the services, appliances and specific fittings have not been tested. All photographs, measurements, floor plans and distances referred to are given as a guide and should not be relied upon.

BUTLER & STAG

☎ 01992 667666

🏠 4 Forest Drive, Theydon Bois, Essex, CM16 7EY

✉ theydon@butlerandstag.com

www.butlerandstag.uk